



EKLIPSE

ACCENT LIGHTING

Designed for specific applications on windowsills, **EKLIPSE** is an LED graphic light shaper, which highlights inner frames or outer edges of windows, balconies or repeating architectural elements, while designing appealing optical effects on buildings façades and creating boundless accent lighting solutions.



EKLIPSE

GRIVEND 

EKLIPSE

GRIVEN 

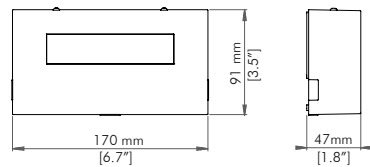

BEAM ANGLE REFERENCE

ELLIPTICAL 13°x127°
ELLIPTICAL WIDE 21°x50°

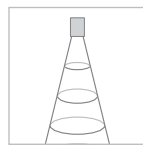

MAX OUTPUT
472 lm
(EL CW configuration)

PHOTOMETRIC DETAILS AVAILABLE ON OUR WEBSITE

FEATURES AND OPTIONS



ACCESSORIES



AL4421
ANTI-GLARE SHIELD



AL4405 01
ELECTRONIC DRIVER (with cables)



AL4424 01
START LINE BOX (with cables)



AL4425 01
REPOWER BOX (with cables)

CODES

AL4373 EKLIPSE

OPTICS	LED TYPE	FINISH	OPTION
EL Elliptical	RN RGB+W 4000K	W White RAL 9003	S Self-addressing
WL Elliptical wide	DW From 2700K to 6500K	G GRIVEN Grey	R RDM
	CW Cold White 6500K	A Anthracite RAL 7016	
	NW Natural White 4000K	B Black RAL 9005	
	WW Warm White 3000K		

TECHNICAL SPECIFICATIONS

EKLIPSE is an IP66 ultra compact LED graphic light shaper, whose aluminium body hosts 4 high brightness RGBW, Dynamic White, Cold White, Natural White, Warm White or, on request, monochrome power LEDs. Dimensions: 170 mm x 47 mm x 91 mm. Available in DMX mode, it also features RDM (Remote device management) and RFU (Remote firmware update) functions, whereas the RDM function is not available when on self-addressing mode. Power supply: 48Vdc. Power consumption: 0.2A @ 230V / 10W max. Separate electronic driver powering up to 24 units (standard configuration). Electrical Class III. Operating temperature: -40°C to 50°C (-40°F to 122°F).

DIGITAL CONTROL SYSTEM SPECIFICATIONS AND CONFIGURATIONS AVAILABLE ON OUR WEBSITE

